

4 Battery Wharf, Unit 4604 | Boston, MA 02109

UNIT 4604
CEILING HEIGHT 8'-1"

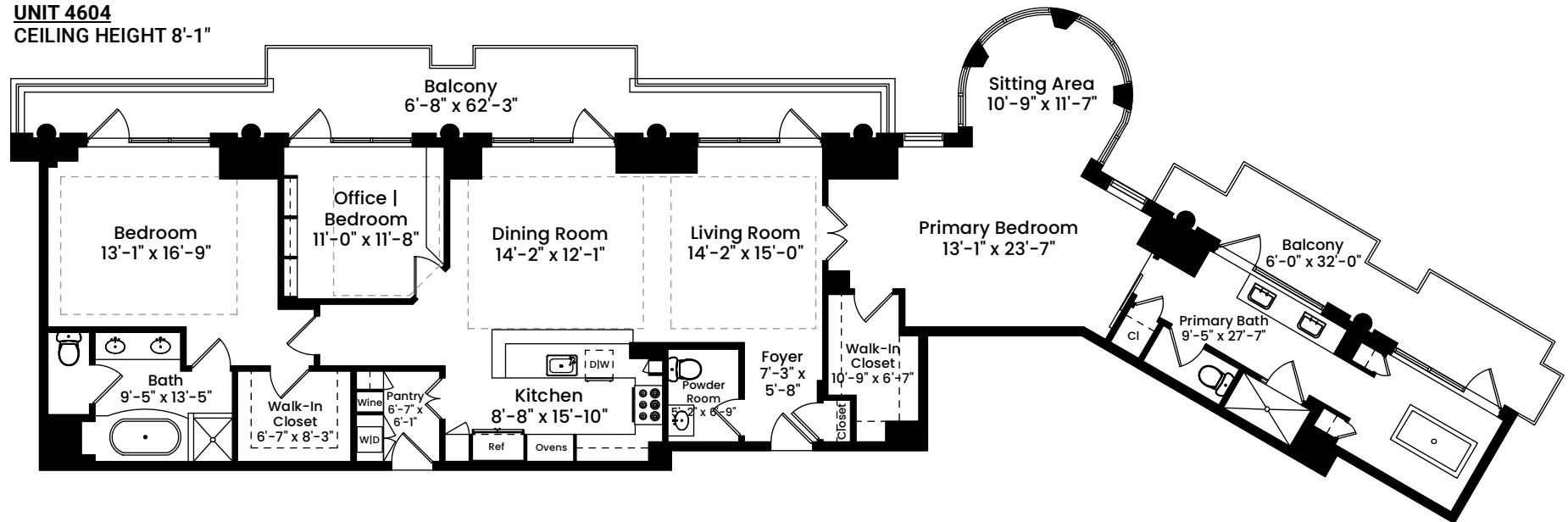

AREA CALCULATIONS	
Total Unit Area	2,068 SF
Balconies	483 SF
Total Area	2,551 SF

Architecturally drafted in October 2024 by:
National Floor Plans (800) 328-0217
Associate Member | American Institute of Architects
Contact www.nationalfloorplans.com for .dwg AutoCAD files
or square footage questions about this property.

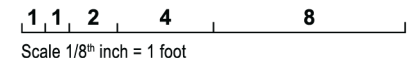

Dimensions are not guaranteed and are provided for informational purposes only.
Individual room dimensions are not used to calculate overall square footage.
National Floor Plans follows ANSI guidelines for calculating square footage.
Unit area has been calculated to the centerline of demising and exterior walls.